

山东中煤工矿物资集团有限公司（简称中煤集团）始建于上世纪九十年代，员工1100余人，现拥有36家专业公司、3家香港公司、1家英国开曼公司、1家美国公司，是国家工信部、商务部、发改委和山东省、济宁市重点培育扶持的大型制造业集团。

中煤集团机械制造公司是专业的机械设备生产制造大型企业，公司现有高级工程师36人、技术人员148人、技工300余人，其中中国设备工程专家库专家5人。

Shandong China coal Industrial and Mining Supplies Group Co., Ltd was founded in the 1990s. It has more than 1,100 employees and now has 36 professional companies, 3 Hong Kong companies, 1 Cayman company and 1 US company. It is a large-scale manufacturing group supported by the Ministry of Industry and Information Technology, the Ministry of Commerce, the National Development and Reform Commission, and the key cultivation supported by Shandong Province and Jining City.

Shandong China Coal Group is a professional large-scale enterprise in the manufacture of machinery and equipment. The company has 36 senior engineers, 148 technicians and more than 300 technicians, including 5 experts in China's equipment engineering expert library.





PRODUCTIVE POWER



CREDIBILITY IS LIFE

Quality for survival

专业的科技人才队伍保障了中煤集团自主研发能力，集团生产的产品90%以上具有核心自主知识产权。主要生产各种规格型号的大型运转设备、支护设备、起重设备、集装设备、物流整理设备、分拣设备、智能机械等产品，以及高技术含量先进的矿建产品和新产品的研发。

The professional scientific and technological talent team has guaranteed the independent research and development capability of China Coal Group. More than 90% of the products produced by the Group have core independent intellectual property rights. It mainly produces large-scale operation equipment, support equipment, lifting equipment, container equipment, logistics equipment, sorting equipment, intelligent machinery and other products of various specifications and models, as well as the development of high-tech mining products and new products.

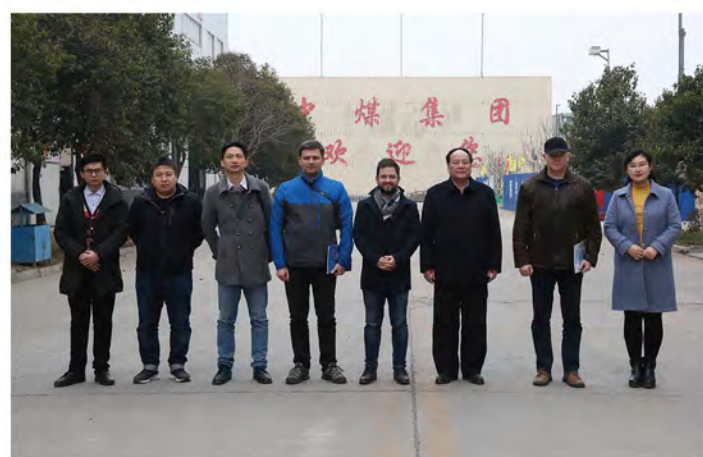

CUSTOMER VISITS

主要生产经营的各种矿建设备器材已销售到全国34个省、直辖市、自治区以及特别行政区，出口美国、俄罗斯、澳大利亚、越南、印度尼西亚、英国、西班牙等153个国家和地区。

The main production and operation of various mining equipment and equipment have been sold to 34 provinces, municipalities, autonomous regions and special administrative regions, and exported to 153 countries and regions such as the United States, Russia, Australia, Vietnam, Indonesia, United Kingdom, Spain....

U STEEL SUPPORT ARCHES FOR MINING TUNNELS



Size	Material	Theoretical Weight (kg/m)	Cross-Sectional Area (cm ²)	Height	Thickness	Width	Leg thickness
25U	Q275B/ 20Mnk	24.95	31.79	+1.0	+0.5	+1.0	+0.8
				120	15	130	6.3
				-1.5	-1.2	-3.0	-0.5
29U	Q275B/ 20Mnk	29.00	37.00	+1.0	+0.5	+1.0	+0.8
				124	16	150.5	7.2
				-1.5	-1.2	-3.0	-0.5
36U	20Mnk	35.87	45.70	+1.0	+0.5	+1.0	+0.8
				138	17	171	7.8
				-1.5	-1.2	-3.0	-0.5
40U	20Mnk	40.05	51.02	+1.0	+0.5	+1.0	+0.8
				149	20.2	171	8.5
				-1.5	-1.2	-3.0	-0.5

Product Details:

U steel is also called mining support steel. It is mainly used to make U steel brackets or arched steel sheds, which are used in coal mine tunnels and roadway support.

U steel can be divided into 25U, 29U, 36U, 40U, according to the weight of meter.

U steel can be divided into 8m, 9m, 10m, 11m, 12m according to the length.

Different

Models Of Products



Horseshoe-shaped five-beam bracket



Miner steel bracket



Single section beam 25U steel bracket



Standard semicircular arch bracket



Round bracket

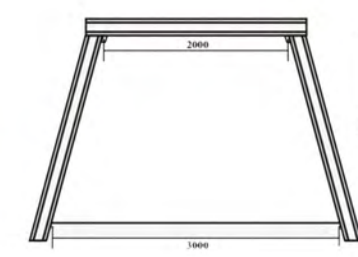

Trapezoidal steel



Three-section beam bracket



Horseshoe-shaped four-section steel bracket

PRODUCT DIAGRAM

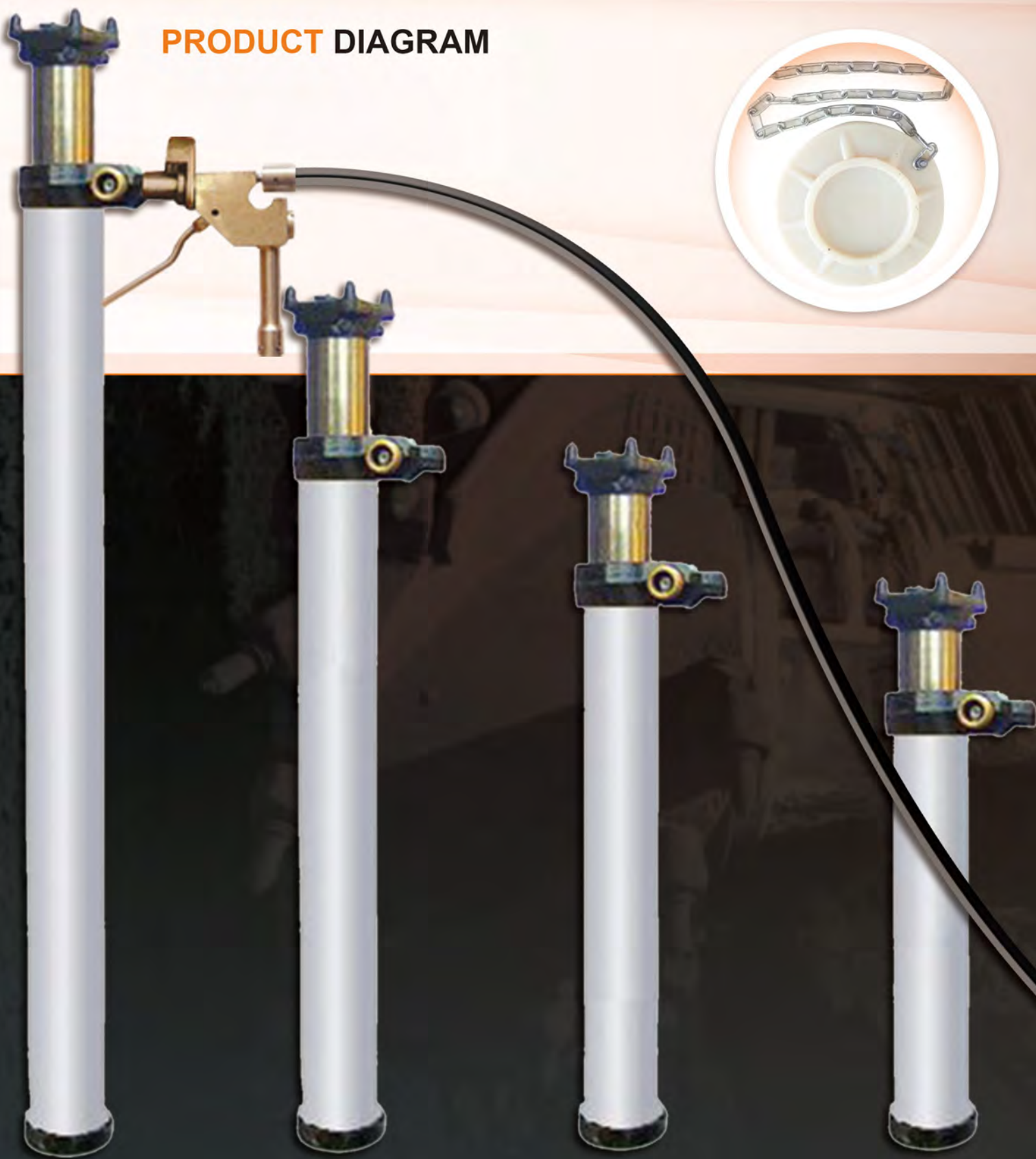

DW MINING HYDRAULIC PROP

Mining hydraulic prop can be used with the metal roof beam for coal seam horizontal and gentle supporting. It can also be used for the end support or temporary support of the integrated mechanized coal mining face, suitable for thickness of 0.5-4.5m. Coal seam. Working with emulsion pumping stations, hoses and liquid injection guns.

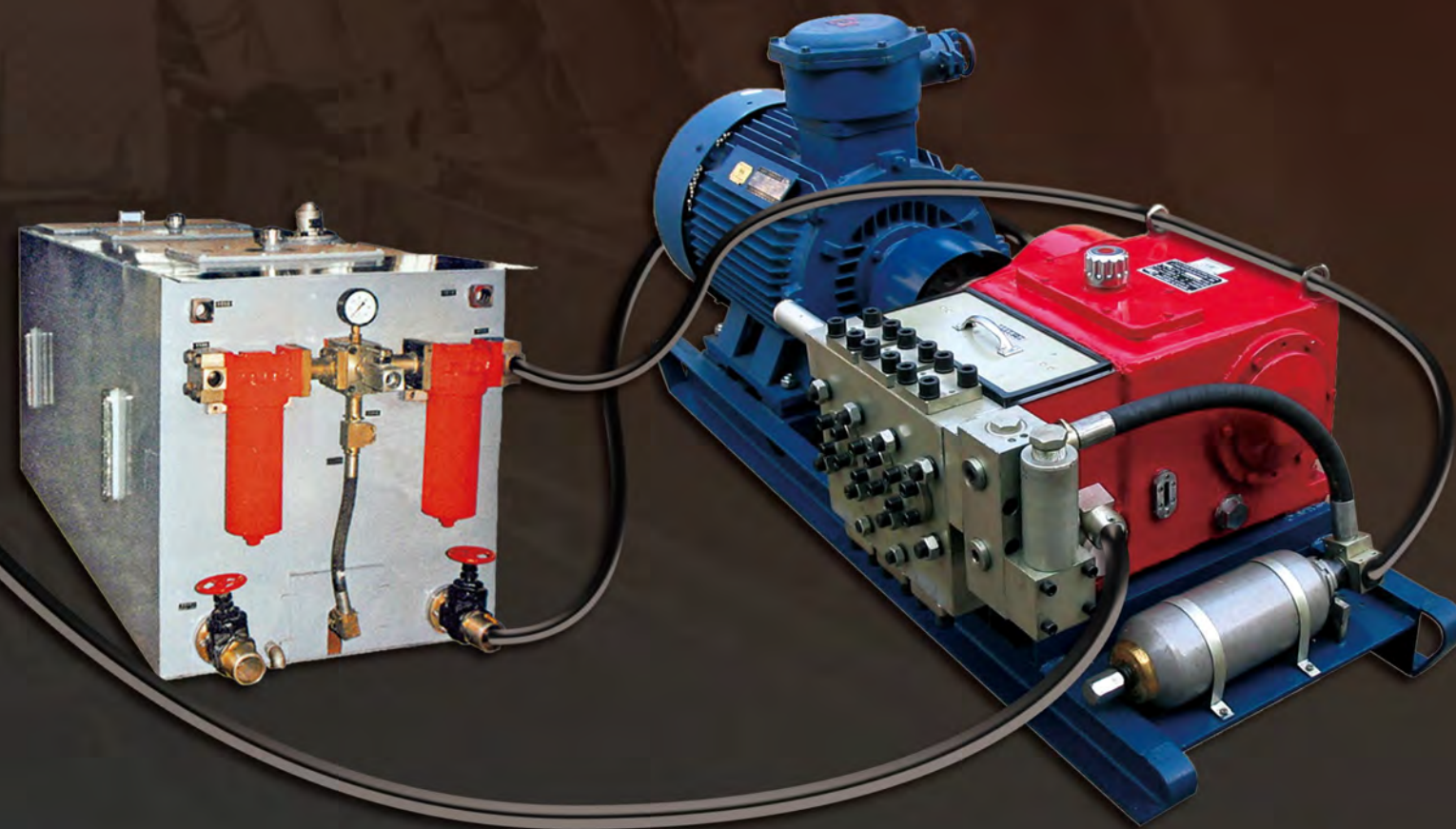

φ100/φ110 Specification

Item Model	Max height (mm)	Min. Height (mm)	Working Stroke mm	Rated working resistance KN	Weight (Kg)	Rated working Pressure MPa	Hydraulic pump pressure MPa	Setting load KN	Cylinder Dia. (mm)	Emulsion Liquid
DW06-350/110X	630	400	230	350	25	39.7	15-20	132-176	110	Emulsion containing 1% to 2% M10 emulsified oil
DW08-350/110X	800	490	310							
DW10-350/110X	1000	595	405							
DW12-350/110X	1200	700	500							
DW14-350/110X	1400	810	590							
DW16-350/110X	1600	920	680							
DW18-350/110X	1800	1035	765							
DW20-350/110X	2000	1150	850							
DW22-350/110X	2240	1280	960							
DW25-350/110X	2500	1430	1070							
DW28-350/110X	2800	1600	1200							
DW31.5-350/110X	3150	1780	1370							
DW35-350/110X	3500	1960	1540							
DW38-250/110X	3800	2163	1637	250	88	28.3				
DW40-250/110X	4000	2224	1780							
DW42-250/110X	4200	2330	1880							
DW45-250/110X	4500	2480	2020							

Normal type Specification

Item Model	Max height (mm)	Min. Height (mm)	Working Stroke mm	Rated working resistance KN	Weight (Kg)	Rated working Pressure MPa	Hydraulic pump pressure MPa	Setting load KN	Cylinder Dia. (mm)	Emulsion Liquid					
DW06-300/100	630	485	145	300	25.1	38.2	15-20	118-157	100	Emulsion containing 1% to 2% M10 emulsified oil					
DW08-300/100	800	578	222												
DW10-300/100	1000	685	315												
DW12-300/100	1200	792	408												
DW14-300/100	1400	900	500												
DW16-300/100	1600	1005	595												
DW18-300/100	1800	1110	690												
DW20-300/100	2000	1240	760												
DW22-300/100	2240	1440	800												
DW25-250/100	2500	1700	800		250						58	31.8			
DW28-250/100	2800	2000	800												
DW31.5-200/100	3150	2350	800		200						78	25.4			
DW35-200/100	3500	2700	800												
DW38-250/110	3800	2800	1000	250		92	26.3								
DW40-250/110	4000	3000	1000												
DW42-200/110	4200	3200	1000	200	106	21.1	147-190	110							
DW45-200/110	4500	3500	1000												

EMULSION PUMPING STATION

An emulsion pumping station is composed of BRW type emulsion pump and the XRXT series emulsion tank. Which mainly provides power source for underground coal mining hydraulic support, and can also be used for ground and other hydraulic equipment.

The pumping station consists of two pumps and one box. One use, one standby. If the job requires, can also be used simultaneously with two pumps.



PRODUCT PARAMETERS

Model	BRW80/20	BRW80/35	BRW125/20C	BRW125/31.5C	BRW160/20A	BRW160/25A	BRW160/31.5A
Input pressure	Normal pressure						
Nominal pressure Mpa	20	31.5	20	31.5	20	25	31.5
Nominal flow L/min	80	80	125	125	160	160	160
Crankshaft speed r/min	517	517	561	561	561	561	561
Number of plungers	/		3	3	3	3	3
Plunger diameter mm	32	32	40	40	45	45	45
Plunger stroke mm	70	70	66	66	66	66	66
Motor Power KW	37	55	55	75	75	75	110
Motor Rotating speed r/min	1470	1470	1480	1480	1480	1480	1480
Motor Voltage V	440/660		660/1140	660/1140	660/1140	660/1140	660/1140
Dimension	Pump L×B×H mm		760×680×432	832×770×454	832×770×454	832×770×454	832×770×454
	Assembly L×B×H mm		1873×760×880	2166×838×980	2166×838×980	2166×838×980	2180×838×980
Weight	Pump kg		460	580	580	580	580
	Assembly kg		923	1023	1560	1600	1600
Emulsified tank volume L	630		1000	1600(1000)	2000(1000)	2000(1000)	2000(1000)
Working medium	Emulsion (neutral water mixture containing 3%-5% emulsified oil)			Emulsion of emulsified oil and neutral soft water in a weight ratio of 5:95			
Safety valve beginning adjustment pressure Mpa	/		22	34.7	22	27.5	34.7
Unloading valve beginning adjustment pressure Mpa	20	35	20	31.5	20	25	31.5
Unloading valve to restore pressure	/		Pump rated pressure 75-85%				
Matching liquid tank	XR40/6.3			X10RX			

DN MINING SINGLE HYDRAULIC PROP

The hydraulic props and the metal roof beam are used for the roof support of the mining face in horizontal or gently inclined coal seams, and can also be used for temporary support, end support of integrated mechanized coal mining or advanced support.



Features:

Needn't external power (pump station and pipeline), flexible, convenient management, lower cost; environmental protection ; working fluid uses 5# hydraulic oil, The department are waterproof, long service life.

The most notable feature is that it can still be used without electric power , which is an indispensable tool for mine rescue.

Model	DN06	DN08	DN10	DN12	DN14	DN16	DN18	DN20	DN22	
Max Height mm	650	800	1000	1200	1400	1600	1800	2000	2240	
Min Height mm	510	590	700	850	1000	1100	1200	1390	1540	
Working Limit mm	140±10	210±10	300±10	350±20	400±20	500±20	600±20	610	700	
Rated Working Resistance kN	250							300		
Rated Working Pressure MPa	49							46.3		
Down Prop Seed mm/s	>20					>30				
Working Medium	5#Hydraulic oil									
Weight kg	23	26	29	34	38	41	45	55	60	
Applicable Coal Seam Thickness m	0.6	0.7~0.8	0.9~1	1.1~1.2	1.3~1.4	1.4~1.6	1.5~1.8	1.6~2	1.8~2.2	

Model	DN25	DN28	DN31.5	DN35	DN38	DN40	DN42	DN45	
Max Height mm	2500	2800	3150	3500	3800	4000	4200	4500	
Min Height mm	1800	2100	2450	2800	3100	3300	3500	3800	
Working Limit mm	700								
Rated Working Resistance kN	250		160			150			
Rated Working Pressure MPa	39.3		25.1			15.7			
Down Prop Seed mm/s	>30								
Working Medium	5#Hydraulic oil								
Weight kg	68	74	78	86	91	95	113	119	
Applicable Coal Seam Thickness m	2.1~2.5	2.4~2.8	2.75~3.15	3.15~3.5	3.15~3.5	3.3~3.8	3.7~4.2	4.0~4.5	

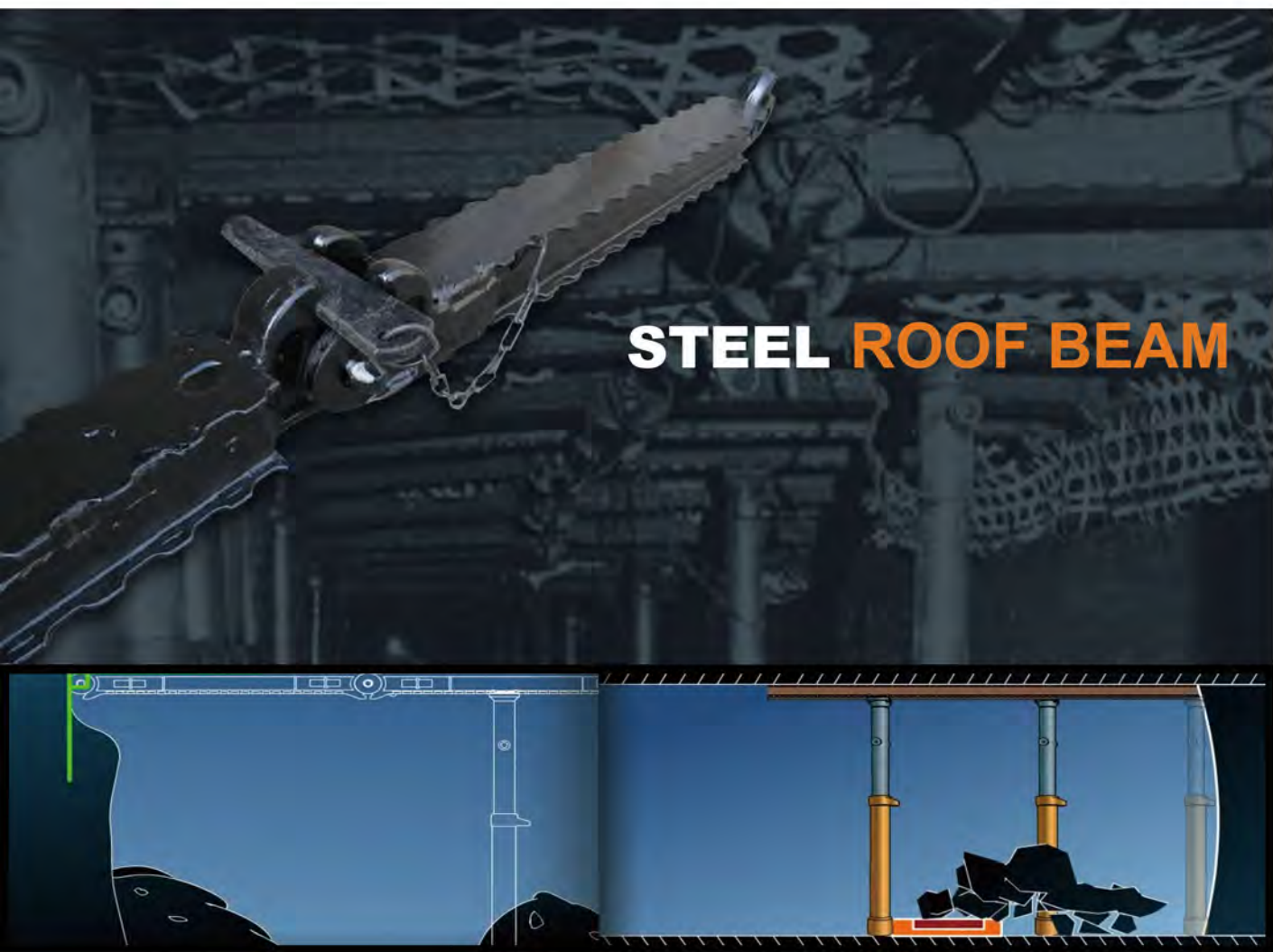

The Steel roof beam sizes are divided into: 0.6, 0.8, 0.9, 1.0, 1.2 m, and >1.2 m extension beams.

The top beam can be combined with a hydraulic prop or various types of single metal prop with hinges to form a metal bracket.

The DJB metal roof beam is a new top beam. The beam body is welded by two #7 π steels, and the other end is welded to the ear connection so that they can be hinged to each other.

Model	Center distance (mm)	Connect number of each time	Permissible bending distance (KN.m)		The Angle		Weight (kg)
			The beam body	Connection articulated	Upper, lower	Left, right	
DJB600/470	600	1-2	52.50	30.00	≥7°	≥3°	18.86
DJB800/420	800	1-2	52.50	30.00	≥7°	≥3°	22.9
DJB1000/300	1000	1-2	52.50	30.00	≥7°	≥3°	26.93
DJB1200/300	1200	1-2	52.50	30.00	≥7°	≥3°	30.95



Mine anchor mesh is a kind of protective equipment that uses wire or steel wire to form a mesh.

Material: woven from high quality low carbon steel wire.

Features: hooked; woven simple, beautiful and practical.

Usage: It can be fixed or tied with bolts on the anchor to form a support form to maintain the surrounding rock between the anchors and prevent small loose rocks from falling.



• **Common widths are:** 180mm, 200mm, 220mm, 250mm, 280mm, 300mm

• **Common thickness is:** 2.5mm, 2.75mm, 3.0mm

• **Common hole diameter is:** 40mm*60mm 30mm*70mm

The length of the w steel belt can be customized according to the actual needs of customers.

Hollow grouting anchor

The hollow grouting anchor body is the grouting pipe. After the grouting slurry is injected, not only the rod body can be anchored, but also a part of the slurry will penetrate into the crack of the anchor hole when the grouting pressure is full, so as to strengthen the surrounding rock.

Features:

- Hollow design to achieve the function of grouting.
- Pressure grouting.
- Total bolt body would be wrapped by mortar, Anti-corrosion.
- Easy to install
- Adopting the upward exhaust anchor head, the problem of exhausting the hollow anchor above the horizontal line is completely solved.

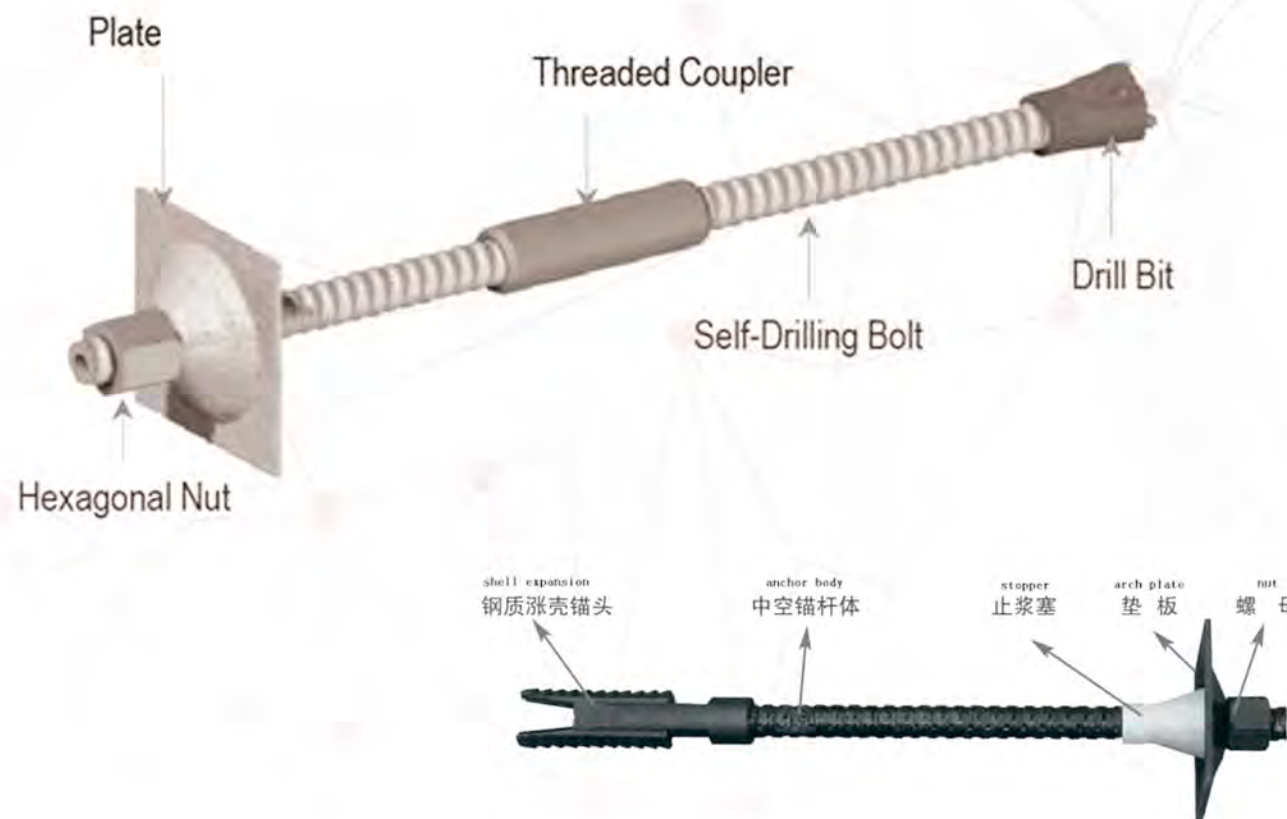
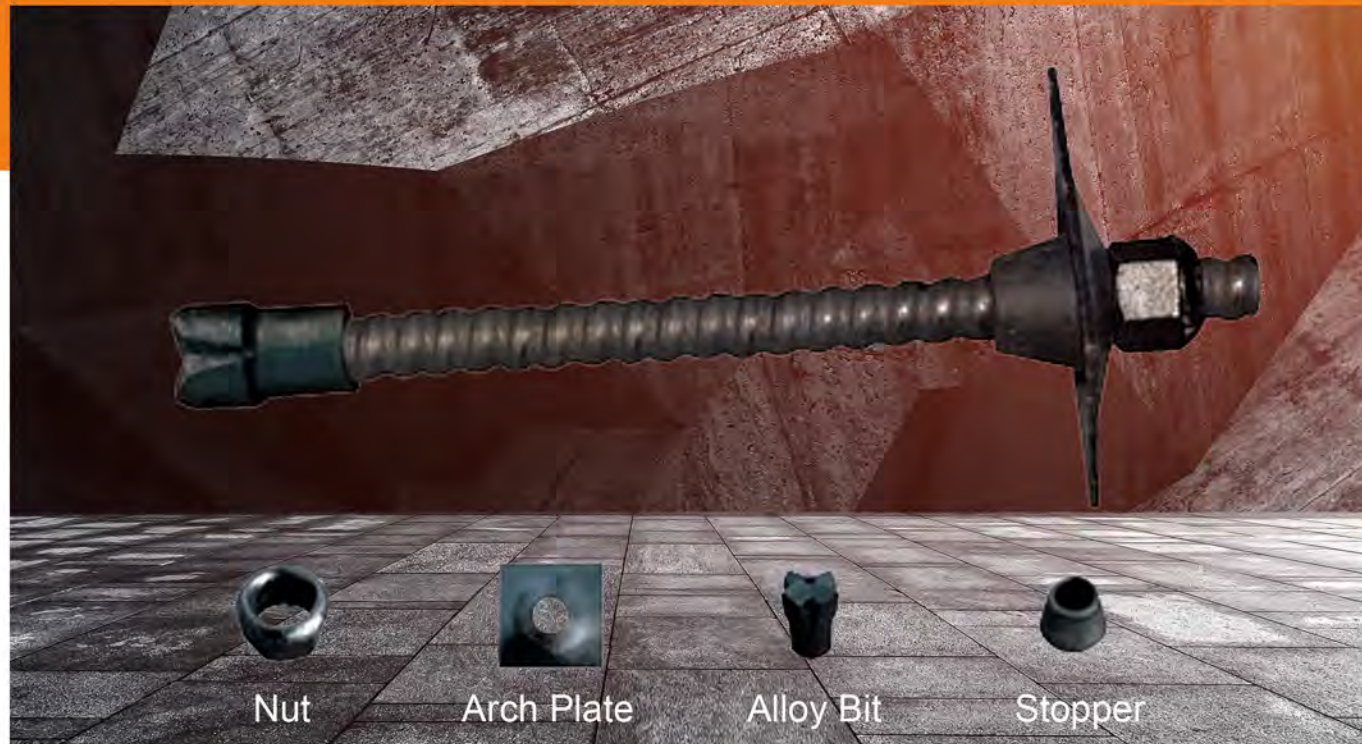

Description	unit	R25	R32N	R32N	R32S	R32SS	R38N	R51N	T30N	T40N	T52	T76N
Outer Diameter	mm	25	32	32	32	32	38	51	30	40	52	76
Inner Diameter	mm	14.5	21.5	20	20	18.5	23	36	15	21	26	52
Area	mm ²	255	331	369	369	407	548	892	331	803	1274	1991
Ultimate Tensile Load	KN	200	280	280	360	400	500	800	260	660	929	1660
Yield Load	KN	150	230	230	280	330	400	630	220	525	730	1200
Ultimate Tensile Strength	Mpa	784	846	758	976	983	912	897	785	822	729	837
Yield Strength	Mpa	588	695	623	759	811	730	706	665	654	573	628
Nominal Weight	kg/m	2	2.6	2.85	2.9	3.2	4.2	7	2.6	6.3	10	15

Friction anchor bolt

The Friction anchor bolt is a longitudinally seamed high-strength steel pipe. When installed in a drill hole slightly smaller than the pipe diameter, it can immediately apply radial pressure to the hole wall and prevent the friction of the surrounding rock from falling over the entire length, plus the support force of the bolt tray pallet.



Features :

1. The raw material is made of high-strength alloy strip;
2. Easy installation;
3. No need anchorage agent;
4. The friction between the anchor and the rock mass is large;
5. Has a high shear and tensile strength;
6. Equipped with high-strength tray, the tray is evenly stressed;
7. The height of the roadway > length of the bolt.

Specifications:

Outer Diameter (mm): $\Phi 30$, $\Phi 33$, $\Phi 40$, $\Phi 43$ (± 0.5);
 Length (mm): 1200, 1500, 1800, 2000, 2500
 Material: Q235, 16Mn, 20 Mnsi.

FRP anchor rock bolt

The FRP anchor is made of unsaturated polyester resin and glass fiber. The main purpose is to strengthen the rock mass, bolt support of the coal mine roadway, railway, tunnel road and other slopes.



Features :

1. Corrosion resistant, acid and alkali resistant to meet permanent support needs.
2. Easy to cut, No sparks when cutting, good for production safety;
3. Light weight than steel anchor, Easy to install and construct
4. High strength: the tensile strength of the rod is ≥ 300 MPa, and the torque is ≥ 40 N·m

Type		MGSL18	MGSL20	MGSL22	MGSL24	MGSL27
Appearance		Uniform texture, no bubbles, cracks				
Diameter(mm)		18	20	22	24	27
Stretch strength(MPa)		500	500	500	500	500
Shear strength(MPa)		100	100	100	100	100
Torque (Nm)		45	55	70	90	120
Antistatic property (Ω)		$\leq 3 \times 10^7$				
Flame retardant performance	Flaming	6 pcs (s)	≤ 30			
		Max single (s)	≤ 15			
	Flameless combustion	6 pcs (s)	≤ 120			
		Max single (s)	≤ 60			
The anchoring force (KN)		60	70	80	90	100
Plate bearing capacity (KN)		60	70	80	90	100
Nut bearing capacity (KN)		60	70	80	90	100

Full Thread Bar anchor bolt

Full Thread bar anchor bolt are used for mine roadway and underground rock support to ensure the stability of surrounding rock in mine roadway and underground engineering. The entire length of the rod body has rolling continuous thread, full length same strength.



FEATURES :

1. Double head do not require machining;
2. Full-length equal strength and high material utilization rate;
3. Large anchoring force;
4. With plates, easy to control the installation quality;
5. Fast Installation speed. It is a new type of bolt with saving material, labor saving and High intensity.

Model	Yield strength (MPa)	Tensile strength (MPa)	Tensile strength (MPa)	Yield load (KN)	Tensile load (KN) Kg/m
φ16	≧ 345	≧ 510	≧ 25	≧ 69	≧ 100 1.6
φ18	≧ 345	≧ 510	≧ 25	≧ 87	≧ 126 2.0
φ18	≧ 345	≧ 510	≧ 25	≧ 108	≧ 156 2.5
φ22	≧ 345	≧ 510	≧ 25	≧ 131	≧ 189 3.0

Sort by solidification time:				
Type	Features	Gel time/s	Waiting time/s	Color sign
CK	Super fast	8~40	10~60	red
K	Fast	41~90	90~180	blue
Z	Medium speed	91~180	480	white

Note: measured at (22 ± 1) °C ambient temperature

Normal size :		
Size Specification	Diameter mm	Length mm
2340	Φ23±0.5	400±10
2355	Φ23±0.5	550±10
2360	Φ23±0.5	600±10
2380	Φ23±0.5	800±10
2680	Φ26±0.5	800±10

Note: The length of the anchoring agent could be customized

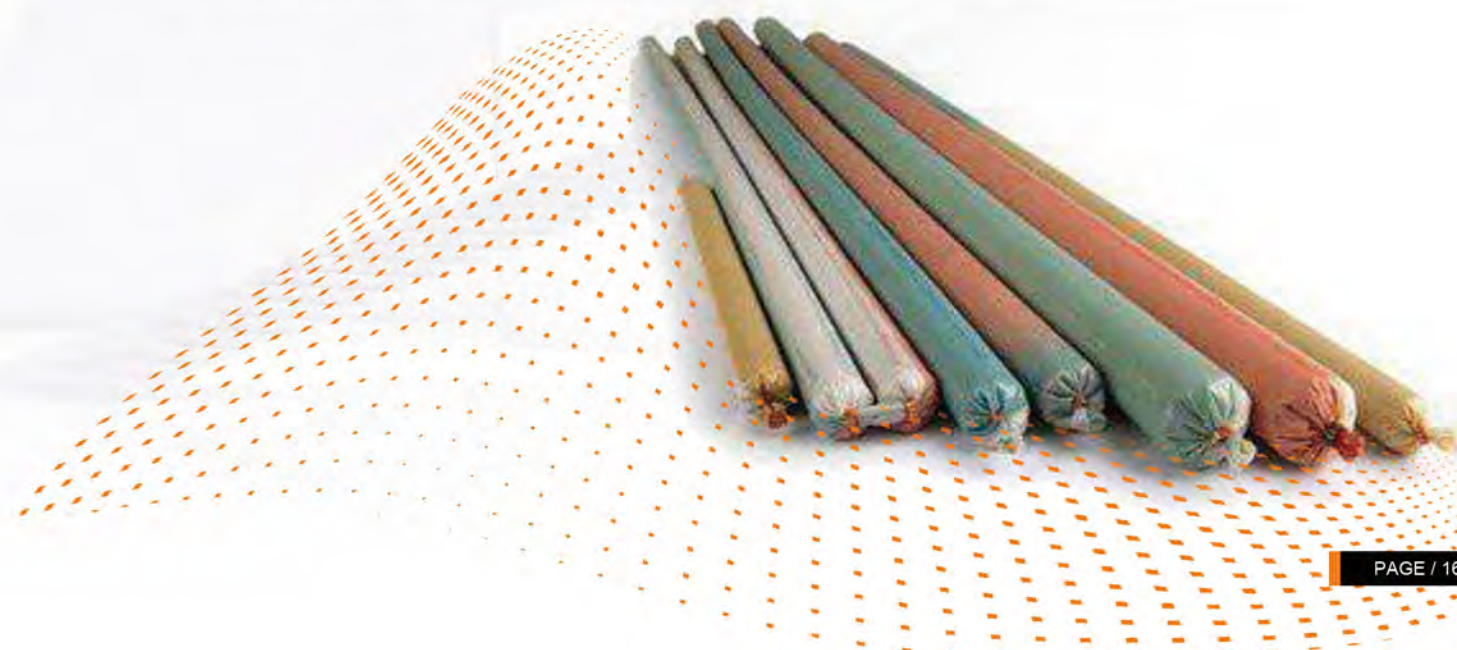



The shotcrete machine mainly uses compressed air to pass the concrete through the material chamber into the machine that continuously transports along the conveying pipe and sprays it onto the construction surface. There are two types of dry type (PZ type) spraying machine and wet type (HSP type) spraying machine. Widely used in underground engineering, hydropower projects, wells, tunnels, culverts and other construction operations.



Model	PZ-3	PZ-5	PZ-7	HSP-5	HSP-7	HSP-9
Output	3.5m ³ /h	5m ³ /h	7m ³ /h	4.0-5.0m ³ /h	5.0-7.0m ³ /h	6.0-9.0m ³ /h
Max. Convey distance	Horizontal	200m	200m	200m	30-50m	30-50m
	Vertical	20m	20m	20m	20m	20m
Water cement ratio	≤0.4	≤0.4	≤0.4	≤0.4	≤0.4	≤0.4
Max. Aggregate. size	Φ20mm	Φ20mm	Φ20mm	Φ15mm	Φ15mm	Φ15mm
Hose inner size	Φ38mm	Φ51mm	Φ64mm	Φ51mm	Φ51/64mm	Φ51/64mm
Operating air pressure	0.4~0.6MPa	0.4~0.6MPa	0.4~0.6MPa	0.3-0.6Mpa	0.3-0.6Mpa	0.3-0.6Mpa
Air consumption	3-4 m ³ /min	7-8 m ³ /min	12-15 m ³ /min	10.0-15.0m ³ /min	10.0-15.0m ³ /min	10.0-15.0m ³ /min
Rotor diameter	350(150)mm	438mm	480mm	438mm	480(160)mm	480(175)mm
Voltage	380v or as your requirement	380v or as your requirement	380v or as your requirement	380v or as your need	380v or as your need	380v or as your need
Overall dimension mm	1040*550*940	1280*700*1280	1600*700*1150	1280*700*1280	2000*800*1300	2000*800*1300
Whole weight	550kgs	600kgs	900kgs	700kg	800kg	900kg

MUCKING MACHINE



TRANSPORT EQUIPMENT

Model	ZWY-60	ZWY-80	ZWY-120	ZWY-180
Excavating Width(mm)	3870	4800	4200	6500
Uninstall Length(mm)	1530	1850	1600	2800
Excavating Height(mm)	2300	2800	1800-2700	4400
Excavating Depth(mm)	450	500	450	800
Unload Height(mm)	1400(Changeable)	1700(Changeable)	1100(Changeable)	2693(Changeable)
Minimum Loading Height(mm)	1350(Changeable)	1350(Changeable)	1200-1600(Changeable)	1700(Changeable)
Unload Distance(mm)	1600(Changeable)	1700(Changeable)	1600(Changeable)	3500(Changeable)
Maximum Rotation Angle(°)	±50	±50	±50	±50
Weight(T)	8.5	8.2	5.8	18.6
Machine Dimension	5000x1490x1650	6100x1700x1800	5600x1650x1700	13088x2350x2600
Loading Capacity(m ³ /hour)	60	80	60	180
Min Turning Radius(mm)	4000	5500	4600	12000
Climbing Ability(°)	≤20	≤25	≤10	≤25
Travelling Speed(m/min)	2-4.5	2-4.5	2-4.5	0.54
Motor Power(kw)	22	30	18.5/22	55
Max. Material passing Size(LxWxH) (mm)	800x550x500	650x700x650	810x580x420	800x780x800
Ground Clearance(mm)	200	230(Changable)	200	380
Applied Working Section (W*H) (m)	≥2x2	≥2.2x2.2	≥2x2	≥3.8x3.8
Nominal Working Pressure(Mpa)	20	25	20	32
Conveying Mode	Scraper/Leather Belt	Scraper/Leather Belt	Scraper/Leather Belt	Scraper/Leather Belt

The Mucking machine is a high-efficiency ore-producing equipment for continuous production. It is mainly used for mine rock roadway and semi-coal rock roadway excavation. It can also be used for water diversion tunnel, railway tunnel construction and loading operation in defense cave construction, greatly improving excavation speed.

According to the walking method, it can be divided into a wheel type and a crawler type . The large-slope crawler type can be used for large sections and roadways with a slope of +25°~-35°.

According to different job requirements, except the bucket, also could install with a breaker and a milling head.



ROCK LOADER

The rock loader is a machine that loads ore or rock in horizontal or gently inclined tunnels. It is mainly used in the roadway excavation of coal mines, metallurgical mines, tunnels, etc., with mine cars or buckets for loading operations.

The advantages are flexible and reliable, and the rock loading productivity is higher.

According to the form of its working mechanism, there are bucket type, crab claw type, vertical claw type and grab type.

According to the terms of walking, there are rail-wheel type and crawler type.

According to the control method, it is divided into electric, remote and pneumatic.

Model	Z-17W	Z-17WYK	ZLKY20	Z-20W	Z-20WYK	ZLKY26	Z-30W	Z-30WYK	ZLKY45	ZQ26
Applicable roadway size W*H/m	1.7*2	1.7*2	2*2.2	2*2.2	2*2.2	2.2*2.5	2.2*2.5	2.2*2.5	2.2*2.5	2.2*2.5
Gauge	600//762/900mm (customized)									
Loading Capacity m ³ /h	20-30	30-40	35-45	30-40	40-50	50-60	50-60	60-70	80-100	50-60
Bucket volume m ³	0.17	0.17	0.2	0.2	0.2	0.26	0.3	0.3	0.45	0.26
Loading width mm	1700	1700	Arbitrarily	2000	2000	Arbitrarily	2400	2400	Arbitrarily	2700
Bucket working height mm	1920	1920	1920	2180	2180	2240	2240	2240	2240	2240
Bucket down height mm	1320	1320	1210	1360	1360		1360	1360	1460	1250
Gradeability			25°			25°			25°	
Size	L mm	2120	2120	2287	2480	2480		2620	2660	2400
	W mm	1130	1130	1372	1380	1380	1380	1380	1520	1090-1380
	H mm	1200	1200	1415	1460	1460	1545	1650	1650	1500
Travel motor power kw	10.5	10.5	Hydraulic Motor 5000N/ 2units	10.5	10.5	Hydraulic Motor 5000N/ 2units	13	13	Hydraulic Motor 5000N/ 2units	8.83
Bucket motor power kw	10.5	10.5	13	13	13	13	15	15	15	14.71
Hydraulic motor power		1.5	7.5		1.5	7.5		2.2	11	
Weight kg	3200	3300	3700	3750	3800	3900	4500	4500	4800	2700

Z-Rock loader; W-No tangled rope; YK-remote control; L-Crawler type; ZLKY-Hydraulic remote control crawler rock loader

Mining

Scraper conveyor

Mining Scraper conveyor is mainly used for transporting coal in thin coal seam or ultra-thin coal seam, general mining, fully mechanized mining and other working faces, and can also be used for driving roadway transportation and smoothing. In the trough transportation, when working with shearer, the middle Flute of the scraper conveyor is also the walking track of the shearer. Scraper conveyor is a conveyor that is pulled by a scraper chain to transport bulk material in a tank. It consists of middle flute, chain, scraper and traction system.

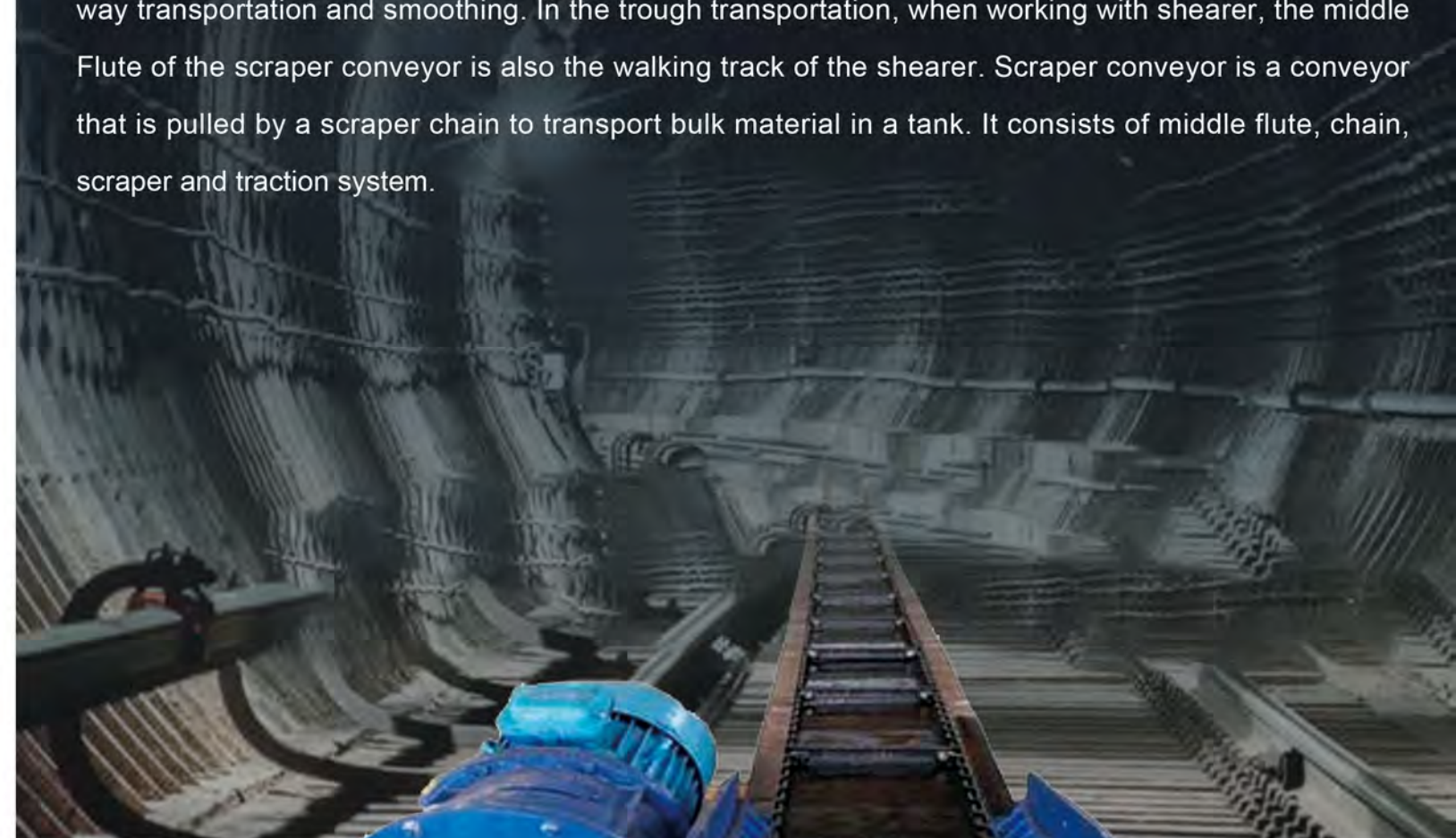

Product parameters

Model		SGB420/30	SGB620/40	SGZ630/264	SGZ730/320
Delivery Capacity(t/h)		80	150	450	700
Standard length(m)		100	100	200	200
Chain speed(m/s)		0.88	0.86	0.95	0.95
Electric motors	Model number	JDSB30	DSB40	YSB-132	YSB-160
	Power(kW)	30	40	2*132	2*160
	Voltage(V)	380/660	380/660	660/1140	660/1140
Scraper chain	Form	Side double-stranded	Side double-stranded	Middle side double chain-stranded	Middle side double chain-stranded
	Chain size (mm)	14×50	18×64	22×86	26×92
	Breaking load(KN)	≥250	≥320	≥900	≥1000
Middle Flute size (L x W x H)		1200×420×150	1500×620×180	1500×630×222	1500×730×275
Total weight(t)		10.6	17.8	/	/

Product accessories



Belt conveyor is widely used in industrial production. It can transport bulk and loose granular materials. Can also be used to transport pieces such as bagged cement. It is one of the most common conveying equipment.

Specifications: Standard conveyor belt width is 500mm, 650mm, 800mm, 1000mm, 1200mm, 1400mm, 1600mm etc. Other special specifications can also be customized according to customer requirements.

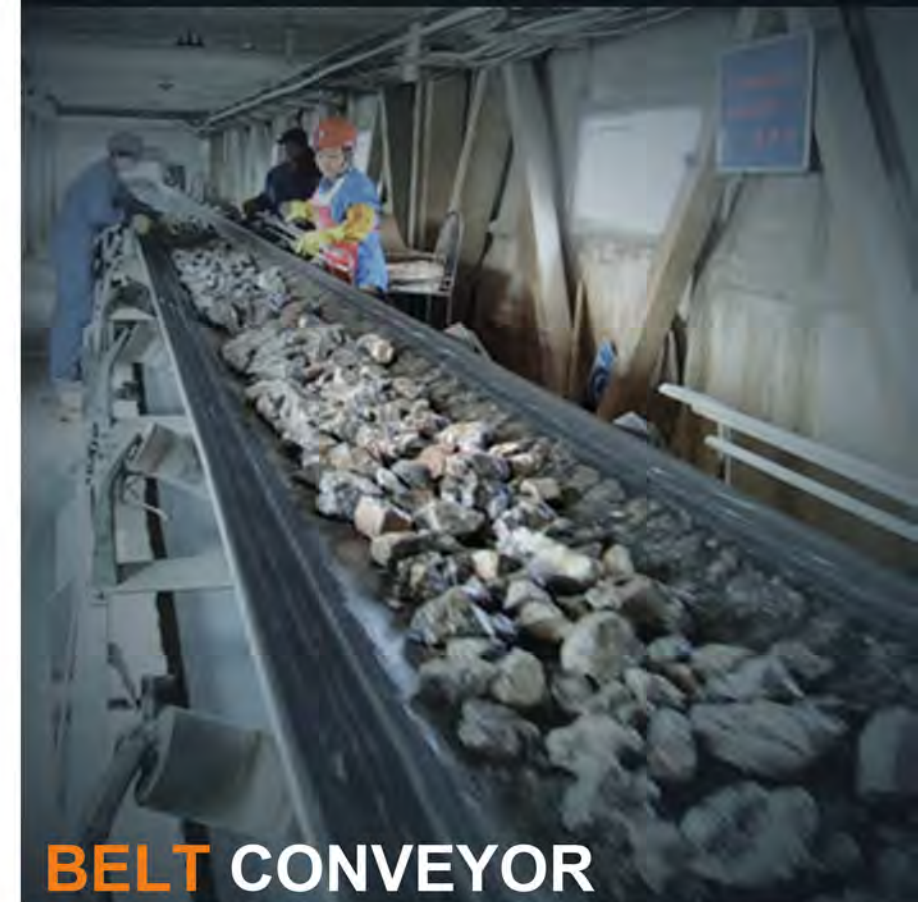

BELT CONVEYOR

Product accessories





Battery mining & Tunnel locomotive

The explosion-proof battery mining locomotive has its own power supply and can be used with the mining cart. Any place with track can be used, so it has strong adaptability and good maneuverability, and is especially suitable for mine excavation work. The explosion-proof battery motor car adopts a no-wire traction network system, which has good safety performance and simple power supply system. It is suitable for transportation systems and roadway excavation transportation with small output and irregular roadway.

Model	CTY2.5/6,7,9G	CTY5/6,7,9G	CTY8/6,7,9G(B)		CTY(L)12/6, 7, 9G	CTY15/6, 7, 9G(B)	CTY18/6, 7, 9G(B)	
Self Weight T	2.5	5	8		12	15	18	
Track Gauge mm	600, 762 or 900mm							
Traction KN	2.55	7.06	11.18	12.83	16.48	18.47	29.4	
Max Traction KN	4.54	12.26	19.62		29.43	36.18	44.15	
Max. Speed km/h	6.13	7	6.2	7.8	8.7	9.6	9.8	
Power Supply Device	Voltage V	48	90	110,132	140,144	192	256	208
	Capacity Ah	308 or 330	385	440		560	620	730
Power	3.5*1	7.5 *2	11*2	15*2	22*1	30x 2	45 x 2	
Size	Length mm	2330	2850	4,500		5100	5200	5100
	Width mm	914,1076 or 1212	920,1082or1220	1050, 1212 or 1350		1050, 1212 or 1350	1500	1500
	Height mm	1550	1550	1600		1600	1920	1900
	Wheelbase mm	650	850	1100	1150	1220	1400	2100
	Wheel Dia mm	Φ460	Φ520	Φ680	Φ600, Φ680	Φ680	Φ680	Φ600
Min. Turning Radius m	5	6	7		10	15	20	
Controller	Resistance or chopper speed regulation	Resistance or Chopped wave	Resistance,IGBT or Frequency conversion		Resistance, IGBT or AC Converter	Resistance, IGBT or AC Converter	Frequency conversion or chopper speed regulation	
Brake Mode	Mechanical	Mechanism or hydraulic pressure	Mechanical		Mechanical and Pneumatic Brake	Mechanical and Pneumatic Brake	Mechanical, electrical, air brake	



KFU
Bucket-tipping mine Car



The Bucket-tipping Mine Car is used on mines or on construction sites to transport bulk material. Such as: coal, stone, etc. It consists of cart box, frame, buffer head, axle, etc. It has a simple structure, sturdy and durable, and is easy to use. It can be easily removed by simply opening the stop plate by hand. Roller bearings are used for the axles, which effectively reduces the running resistance and can be pushed by manpower.

Model	Volume (m ³)	Load (T)	Gauge (mm)	Wheel Base (mm)	Wheel Diameter (mm)	Traction (KN)	Traction Height (mm)	Overall Size (LxWxH)
KFU0.55-6	0.55	1.3	600	500	300	60	320	1552*850*1150
KFU0.75-6	0.75	1.88	600	600	300	60	320	1700*980*1250
KFU1.0-6	1.0	2	600	600	300	60	320	1910*1070*1320
KFU1.2-6	1.2	3	600	700	300	60	320	2228*1070*1320



MCC
Side-discharging mine car

The MCC side-discharging mine car is a kind of high-efficiency, self-unloading operation equipment, which is incapable of itself and needs mine loading and unloading equipment for use with the traction locomotive. One or both sides of the car can be opened, and the mine car is tilted by means of an unloading curved track mounted on the unloading point, and the pull bar opens the side door for unloading.

Model	Volume (M ³)	Load(T)	Gauge (mm)	Wheel base (mm)	Wheel diameter (mm)	Traction height (mm)	Traction Speed (kg/h)	Uninstall Angle	Turning Radius	Weight (Kg)
MCC1.2	1.2	3	600/720/900	600	300	320	12	40	10	1000
MCC1.6	1.6	4	600/720/900	800	350/400	320	12	42	12	1663
MCC2	2	5	600/720/900	1000	400	320	12	42	12	1830
MCC2.5	2.5	6.25	600/720/900	1200	400	320	12	42	12	2505
MCC3	3	7.5	600/720/900	1400	350	320	12	42	12	3050
MCC3.5	3.5	8.5	600/720/900	1600	350	320	12	42	12	3500
MCC4	4	10	600/720/900	2000	350	430	8	42	15	3850
MCC5	5	12.5	600/720/900	2000	350	430	8	42	15	4350
MCC6	6	10	600/720/900	2000	350	500	8	42	15	4900

MPC Mining flatbed mining cart



MPC mining flatbed mining cart is a transportation tool suitable for all kinds of metal, non-metal, coal and other mining transportation equipment and materials. The mining flatbed cart has a simple structure, is easy to maintain, has a large bearing capacity, a low center of gravity, and is widely used. Suitable for underground mining, transporting equipment or other items along underground roadways and surface industrial sites.

Model	loading (T)	Rail gauge (mm)	L(mm)	W(mm)	H(mm)	Wheel base (mm)	Wheel Dia. (mm)	Pulling Height (mm)	Weight (kg)
MPC2-6	2	600	2000	880	410	550	300	320	490
MPC3-6	3	600	2400	1050	415	750	300	320	530
MPC5-6	5	600	3450	1200	480	1100	350	320	900
MPC5-9	5	900	3450	1320	480	1100	350	320	910
MPC10-6	10	600	3460	1300	304	1100	250	230	910
MPC10-9	10	900	3460	1300	304	1100	250	230	1030
MPC13-6	13	600	3350	1400	342	1000	300	270	1015
MPC15-6	15	600	3460	1300	357	1100	300	320	1160
MPC15-9	15	900	3460	1300	357	1100	300	320	1240
MPC18-6	18	600	3350	1400	346	1300	300	270	1132
MPC20-6	20	600	3460	1300	364	1300	300	320	1240
MPC20-9	20	900	3460	1300	364	1300	300	320	1320
MPC25-6	25	600	3460	1300	390	1300	350	320	1750
MPC25-9	25	900	3460	1300	390	1300	350	320	1800
MPC26-6	26	600	2400	1462	390	1300	240	280	1133
MPC30-6	30	600	3460	1300	400	1300	350	320	170
MPC30-9	30	900	3460	1300	400	1300	350	320	1900



MLC Material mining car

MLC material mining car are suitable for underground mining mines, transporting support materials and other materials along underground roadways and surface industrial sites. A vehicle that transports pits, supports, or other materials on a narrow-rail railway in a coal mine floor and a underground roadway.

Model	MLC2-6	MLC3-6	MLC5-6	MLC3-9	MLC5(3)-9
Load capacity (t)	2	3	5	3	5
Gauge(mm)	600	600	600	900	900
Dimension(mm)	2000*880*1150	1050*1200*1200	3450*1200*1200	2100*1150*1300	3450*1230*1200
Wheel base(mm)	550	750	1100	900	1100
Wheel diameter(mm)	300	300	350	350	350
Height of towing attachment(mm)	320	320	320	320	320
Allowed traction(kn)	60	60	60	60	60
Overall weight(kg)	520	520	920	790	940

Shuttle car



Shuttle mining cars are new high-efficiency outbound transportation equipment for underground mines, railway tunnels, hydraulic culverts, and national defense underground projects. The shuttle car has large and small specifications and can be used for small, medium and large sections of roadway excavation. It has 4-40 cubic meters and other specifications and can be used as a large storage device.

Item	Model									
	SD-6B	SD-8B	SD-12B	SD-14B	SD-16B	SD-20B	SD-25B	SD-30B	SD-35B	
Volume (m ³)	6	8	12	14	16	20	25	30	35	
Self weight(t)	8.5	10.2	12	13.6	17.8	19.84	22.6	28.3	35.5	
Load capacity (t)	15	18	25	28	32	40	50	68	75	
Gauge (mm)	600/762/900									
Dimensions (mm)	length	7085	9540	9540	11255	12840	12900	14390	17800	19800
	width	1500	1600	1450	1720	1770	1770	1650	2050	2050
	height	1730	2010	2270	2310	2600	2660	2960	2785	2985
Minimum turning radius (m)	15	15	15	22	25	22	25	30	35	
Loading height (m)	1.2	1.45	1.45	1.4	1.52	1.4	1.7	1.7	1.8	
Loading time (min)	1.2	1.5	2	2	4	4	4	4.5	5	
Maximum operating speed (km/h)	15									
Maximum motor power (kw)	13	13	18.5	18.5	18.5×2	22×2	22×2	30×2	30×2	
Bogie center distance (mm)	3600	5400	5400	5450	6250	6250	6863	7250	7600	

Steel wheel set



Steel wheel set is to ensure the running and steering of the rolling stock on the rail, to withstand all static and dynamic loads from the rolling stock, to transfer it to the rail, and to transfer the load due to the unevenness of the line to the parts of the rolling stock.

Model	Mine Car Weight (kg)	Track (mm)	Wheel Diameter (mm)	Max Axle Distance of wheels (mm)	Min distance of covers (mm)	Axle diameter (mm)
ZBL600/300	≤2400	600	300	808	510	60
ZBL762/300		762		970	672	
ZBL900/300		900		1108	810	
ZBL600/350	≤6700	600	350	850	490	80
ZBL762/350		762		1012	652	
ZBL900/350		900		1150	790	
ZBL600/400	≤9000	600	400	870	476	95
ZBL762/400		762		1032	638	
ZBL900/400		900		1170	776	

Mining man car

XRB series mine man car is one of the safety equipment for all kinds of mine inclined shaft transport personnel. It is suitable for 18-43 kg/m rail, wooden sleeper, cement pillow and cement monolithic track bed. The angle of use is 10- 40 degree inclined shaft.

The car is towed by a winch or hoist. It can be operated independently by the first car or with a certain number of trailers. The number of vehicles to be hung depends on the inclination angle of the mine. The car is equipped with self-braking and manual. Operate two kinds of braking methods, such as breaking rope or accident, braking by yourself or manually.



EQUIPMENT Operation



蓄电池电机车
Battery electric locomotive



翻斗式矿车
Bucket-tipping mine Car



底卸式矿车
Bottom discharging mine car



侧卸式矿车
Side dump car



单侧曲轨侧卸式矿车
Side-discharging mine car



平板车
Flat car



材料车
Material car



防爆三轮车
Explosion-proof tricycle



斜井人车
Mining Man car



扒渣机
Mucking machine



电动装岩机
Electric rock loader



刮板输送机
Scraper conveyor

Specification	XRB15-6/6	XRB15-9/6	XRC6-6/3	XRC8-6/6	XRC10-6/6S	XRC15-6/6S	PRC6	PRC12	PRC18	
Largest traction (kn)	60	30	60	60	60	60	30	30	30	
Maximum travel speed (m/s)	4	3	4	4	4	4	3	3	3	
Angle	10°-40°		10°-30°				0°			
Horizontal Turning Radius (m)	12		8		12		8			
Weelbase (m)	1.2		1250	1250	Bogie axis distance 3.2					
Gauge (mm)	600	900	600/720/900 Customized				600	600	762/900	
Number of bearable persons	15	15	6	8	10	15	6	12	18	
Weight (kg)	First car	2200	2445	1010	1168	1520	1595			
	Tail Car	1000	1200	1287	1205	1555	1630			
Dimension	L mm	4385	4385	3285	3530	4930	4930	3100	4280	4280
	W mm	1200	1400	1050	1226	1050	1226	1020	1020	1300
	H mm	1538	1538	1474	1474	1474	1474	1580	1552	1552

HYDRAULIC mine drilling rig machine



Hydraulic mine drilling rig machines are mainly used for water exploration, gas drainage, dust-proof water injection, various engineering holes and geological structure holes at different angles in the mine, and can also be used for mine exploration and core taking. Also for carbide (diamond) drill bit rotary drilling, and be matched with different drill pipe and drill bit to adapt to different drilling requirements.

The whole machine is composed of four parts: main engine , pump station, control console and crawler body. It adopts double pump system.

Item	unit	ZDY660	ZDY1250S	ZDY1900S	ZDY3200S	ZDY4000S
Rated torque	N.m	660	1250N.m	1900N.m	3200N.m	4000N.m
Drilling depth	m	150/100	300/200/100M	300/200/100M	300/200/100M	350/200/100
Drill pipe diameter	mm	Φ42/Φ50	Φ42/Φ50/Φ63.5	Φ63.5/Φ73	Φ63.5/Φ73	Φ63.5/Φ73
Drilling angle	°	±90°	0~±90°	0~±90°	0~±90°	0~±90°
Rated Rotating speed	r/min	50-300	50-250r/min	50~270r/min	50~210r/min	50~280r/min
Pushing ability	KN	27	36KN	77KN	77KN	100KN
Pulling ability	KN	40	52KN	112KN	112KN	150KN
Push/Pull stroke	mm	650	600	600	800	800
Min. working height	mm	1000	1000	1000	1000	1100
Max.Working height	mm	2100	2100	2100	2100	2100
power	KW	15	22KW	37KW	37KW 45KW	55KW
Whole Machinery weight	kg	1100kg	1350kg	2100kg	2200kg	2500kg
Drill machine weight	kg	600kg	800kg	1250kg	1200kg	1500kg

YT series air leg pneumatic rock drilling machine

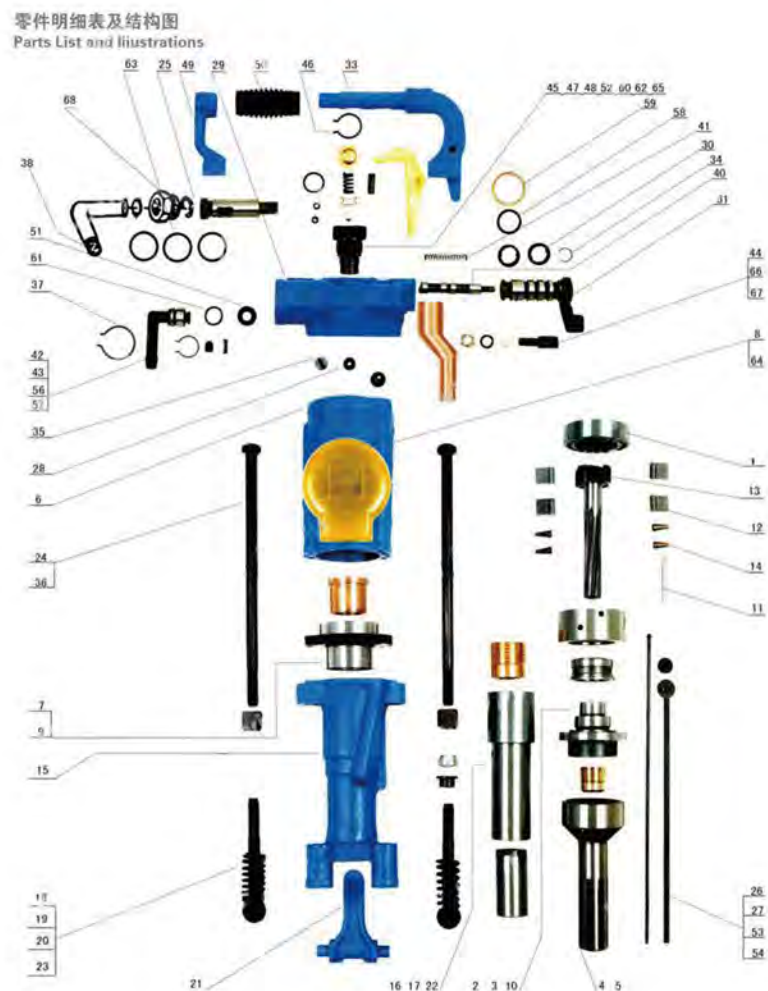

[YT28型凿岩机分解图] YT28 SL80 ILLUSTRATION

Model	YT24	YT27	YT28	YT29A	7655	YSP45
Weight	24kg	27kg	28kg	26.5kg	24kg	26kg
Length	678mm	668mm	661mm	659mm	668mm	661mm
Air pressure	0.4-0.63Mpa	0.4-0.63Mpa	0.4-0.63Mpa	0.4-0.63Mpa	0.4-0.63Mpa	0.4-0.63Mpa
Impact frequency	≧31HZ	≧39HZ	≧37HZ	≧37HZ	≧31HZ	≧28HZ
Air consumption	≧67L/s	≧86L/s	≧81L/s	≧65L/s	≧52L/s	≧82L/s
Impact energy	≧65J	≧75J	≧70J	≧70J		
Cylinder*stroke	70mm*70mm	80mm*60mm	80mm*60mm	82mm*60mm	70mm*70mm	80*60mm
Air pipe diameter	19mm	19mm	25mm	25mm	25mm	25mm
Shank dimension	22*108mm	22*108mm	22*108mm	22*108mm	22*108mm	22*108mm
Drilling depth	5m	5m	5m	5m	5m	5m
Bit diameter	34-42mm	34-45mm	34-42mm	34-45mm	34-42mm	34-42mm

MQT/MQTB series air leg Anchor drilling machine



Model	Unit	MQT-85/1.8			MQT-100/3.1			MQT-120/2.8			MQT-130/3.2		
Air pressure	Mpa	0.40-0.63			0.40-0.63			0.40-0.63			0.40-0.63		
Rated pressure	N.m	0.5			0.5			0.5			0.5		
Water flushing pressure	mpa	0.6-1.2			0.6-1.2			0.6-1.2			0.6-1.2		
Rated torque	N.m	≥85			100			110			130		
Rated rotation speed	R/min	240			280			220			240		
Velocity without load	mm/s	≥680			400			≥560			400		
Max. Output power	Kw	≥1.8			3.1			2.8			3.2		
Stalling torque	N.m	180			180			210			210		
Max. Load torque	N.m	≥185			170			220			190		
Air consumption	M3/min	2.9-3.8			≤3.8			4.4			≤4.5		
Noise	Db(A)	≤90			≤90			≤90			≤95		
Leg type		I	II	III	I	II	III	I	II	III	I	II	III
Leg propulsion	kN	5.2	6.7	9.8	5.2	6.7	9.8	5.2	6.7	9.8	5.2	6.7	9.8
Overall Max.height	mm	2450	3050	3650	2566	3046	3614	2552	3032	3600	2540	3015	3600
Overall Min.height	mm	1185	1268	1418	1189	1309	1451	1175	1295	1437	1365	1725	2145
Weight	kg	44	46	49	45	47	49	48	50	52	50	52	55
Rock drill rod	mm	B19 B22											
Rock drill diameter	mm	φ25-32											

DRILLING EQUIPMENT



Ground water Drilling Rig



Hydraulic Tunnel Drilling Rig



MQT Anchor Drill



ZQS Series Drill



Rail Drill



YN27 Gasoline Rock Drill



Hydraulic Rock Drill



YT Rock Drill



B87C Breaker



TPB breaker



Pick Brazing



Bit



MQ Pneumatic Anchor Cable Tension Machine



LDZ Hydraulic Anchor Cable Tension Machine

LIFTING EQUIPMENT

2JPB Scraper winch

2JPB Scraper winch is mainly used for underground coal or metal mines handling and filling operations. It is mainly used for horizontal haulage or slopes with small dip angles and cannot be used as lifting equipment. The worker can operate by hand next to the winch, or it can be operated with a button from a few meters to several tens of meters from the winch.

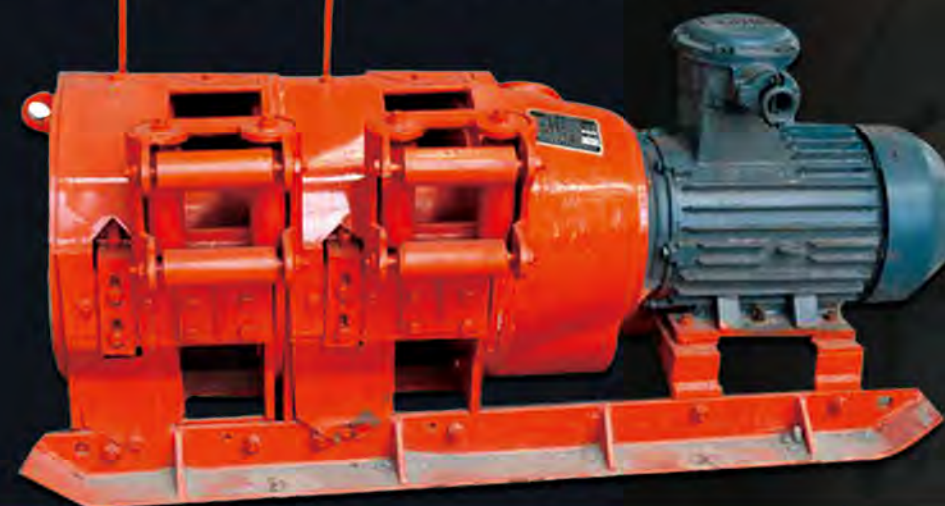

Item	unit	Model					
		2JPB-7.5	2JPB-15	2JPB-22	2JPB-30	2JPB-55	
Main wire rope Min. tension	N	8000	14000	20000	275000	44000	
Average speed	Main wire rope	1.0	1.10	1.20	1.20	1.20	
	Secondary wire rope	±5% 1.0	1.50	1.50	1.60	1.80	
Wire rope diameter	Main wire rope	9.3	12.5	14.0	15.5	18.5	
	Secondary wire rope	9.3	11.0	11.0	14.0	16.0	
Drum	Dia.	205	225	280	280	350	
	Rim diameter	350	435	510	510	625	
	Width	80	125	160	160	180	
Wire Rope Size	Main Drum	45	80	80	80	100	
	Secondary Drum	45	100	100	110	130	
Electric motor	Model	/	YBK ₂ -132M-4	YBK ₂ -160L-4	YBK ₂ -180L-4	YBK ₂ -200L-4	YBK ₂ -250M-4
		/	Y ₂ -132M-4	Y ₂ -160L-4	Y ₂ -180L-4	Y ₂ -200L-4	Y ₂ -250M-4
	Power	KW	7.5	15	22	30	55
	Rotating speed	r/min	1440	1460	1470	1470	1470
Dimensions	L	mm	1210	1525	1600	1650	2070
	W	mm	565	660	730	820	1010
	H	mm	490	620	640	700	890
Total weight (excluding skips and pulleys)		kg	390	660	980	1155	2125

JD series dispatch winch

The JD series dispatch winch is mainly used for underground mine dispatching or assisting traction. It can also be used for scheduling and other transportation work on mine floors, metallurgical mines or construction sites.

It consists of a motor, a winch assembly, a brake master/hydraulic push rod, a base, and a shroud. The structure adopts two-stage planetary gear transmission, high efficiency, convenient operation, low noise, safe and reliable braking.



Model specification	JD-1	JD-1.6	JD-2.5	JD-4
Wire rope static tension KN	10	16	25	40
Wire Rope speed (m/s)	Min.	0.433	0.733	0.95
	Max.	1.033	1.399	1.48
	Average	0.733	1.066	1.22
Wire Rope Size	Wire Rope Dia. (mm)	12.5	15	18.5
	Length (m)	400	400	500
Drum Size mm (Dia.×Width) (mm)	Φ224×304	Φ310×400	Φ620×580	Φ580×600
Total Reduction Ratio	41	32.5	42.24	32.75
Dimension	1120×766×727	1435×1217×1255	1830×1794×1390	2200×1965×1425
Weight (with motor) (kg)	542	1370	2500	3750
Explosion motor	Model	YBJ-11.4	YBJ-25	YBJ-40
	Power (KW)	11.4	25	40
	Revolution (r/min)	1460	1465	1470
	Voltage (V)	380/660	380/660	380/660

JTP series mining lifting winches

JTP series mining lifting winches are mainly used for mine floor shafts and inclined shaft lifting materials, personnel and equipment, can also be used for underground transportation and sinking bucket lifting.

It can be single drum winch and double drum winch.



Model	Drum		Max. Wire rope tension KN	Wire Rope Max. Length m			Wire rope		Average lifting speed m/s	Electric motor		Dimension	Weight
	Diameter mm	Width		The first layer	The second layer	The third layer	Max Dia mm	Breaking pull sum		Rotating speed r/min	Power KW		
JTPB-1.2*1.0	1200	1000	30	170	344	516	20	275	1.88-2.4	967	55-75	4658*2680*1450	10421
JTPB-1.2*1.2	1200	1200	30	203	412	620	20	275	1.57-2.4	967	55-75	4458*2680*1450	9940
JTPB-1.6*1.2	1600	1200	45	215	433	655	26	405	1.56-4	975	95-155	5224*2800*1925	15195
JTPB-1.6*1.5	1600	1500	45	269	542	819	26	405	1.56-4	975	95-155	5524*2800*1925	15678
JKB-2 X1.8P	2000	1800	62	332	670	1013	32	558	2.5	735	200	6410*3234*2600	25560
JKB-2 X1.5P	2000	1500	62	277	557	842	32	558	2.5	735	200	6160*3234*2600	24780
JKB-2.5X2P	2500	2000	83	373	755	1143	40	747	3	740	315	6700*3610*2600	36998
JKB-2.5X2.3P	2500	2300	83	429	867	1312	40	747	3	740	320	7000*3610*2600	39620

Shaft sinking winch

Shaft sinking winch is mainly used for some equipment and material lifting in coal mines, metal mines and non-metallic mine shafts. It can also be used for other underground and ground lifting Heavy objects.

It has the advantages of strong lifting capacity, large capacity and stable operation.



Model	JZ10/800	JZ16/800	JZ16/1000	2JZ16/1000	JZ25/1000	JZ40/1000	JZ40/1800
Wire rope Max. Static tension (KN)	100	160	160	160	250	400	400
Wire rope Capacity (m)	800	800	1000	1320	1000	1000	1800
Drum specification	Diameter (mm)	800	1000	1000	1000	1050	1250
	Width (mm)	820	1400	1400	1400	1210	1480
	Center height (mm)	900	1050	1050	1050	1326	1500
Wire rope diameter	32	40	40	40	52	60	60
Number of winding layers	8	7	7	8	10	9	10
First layer rope speed	Fast (m/min)	5	4.7	4.7	4.7	4.8	5.2
	Slow (m/min)	2.5	2.5	2.5	2.5	2.5	2.5
Electric motor	Model	YRT250M2-8	YRT250M2-8	YRT250M2-8	YRT280S-8	YRT280S-8	YRT355S-8
	Power (KW)	22	30	30	55	45	90
	Speed (RPM)	730	730	730	723	723	730
	Voltage (V)	380	380	380	380	380	380
Dimensions	Length (mm)	2883	3600	3600	5726	3980	4725
	Width (mm)	2962	3280	3280	3806	3935	4593
	High (mm)	1728	2300	2300	2988	2620	3300
Weight (kg)	7480	11500	11500	18000	14680	35000	3800

JYB series transport winches

JYB series transport winches are explosion-proof type, mainly used for underground mining or other auxiliary handling work in underground mines or other roadways with inclination angle less than 30 degrees. This product is strictly forbidden to be used for lifting and manning, and spread Off switch and brake at the same time!



Item	JYB-40×1.25	JYB-50×1.4	JYB-60×1.25	Mark
Wire Rope Size (m)	650	650	650	
Wire Rope Dia.(mm)	φ22	φ24	φ26	
First layer Wire rope static tension (KN)	40	50	60	
First layer Wire rope speed (m/s)	1.25	1.4	1.25	
Drum size (mm)	φ580×600	φ610×600	φ720×800	
Motor	Model	YBK2-280M-6	YBK2-280S-4	YBK2-315M-6
	Power (kw)	55	75	90
	Voltage (V)	380/660 660/1140	380/660 660/1140	380/660 660/1140
	Rotating speed (r/min)	980	980	980
Explosionelectric hydraulic pusher	BYT-180/12	BYT-180/12	BYT-180/12	
Subsidiary Electrical equipment	Explosion magnetic starter	QBZ-120N/660(380)	QBZ-120N/660(380)	QBZ-200N/660(380)
	Explosion control button	LA81-3A	LA81-3A	LA81-3A
Weight (Including motor) (kg)	4620	4620	6200	
Dimension (L*W*H) (mm)	2520×2280×2150	2520×2280×2150	2665×2523×2150	

JSDB Series double-speed winch

JSDB Series double-speed winch is an explosion-proof winch, which is mainly used for the shifting, dumping and handling of the mining materials under the coal mine. The mine raises and lowers the heavy objects on the working surface or the roadway with a dip angle of less than 30 degrees. The double-speed winch has two speeds, fast and slow, which can be used to change speed and traction according to the needs of the site.

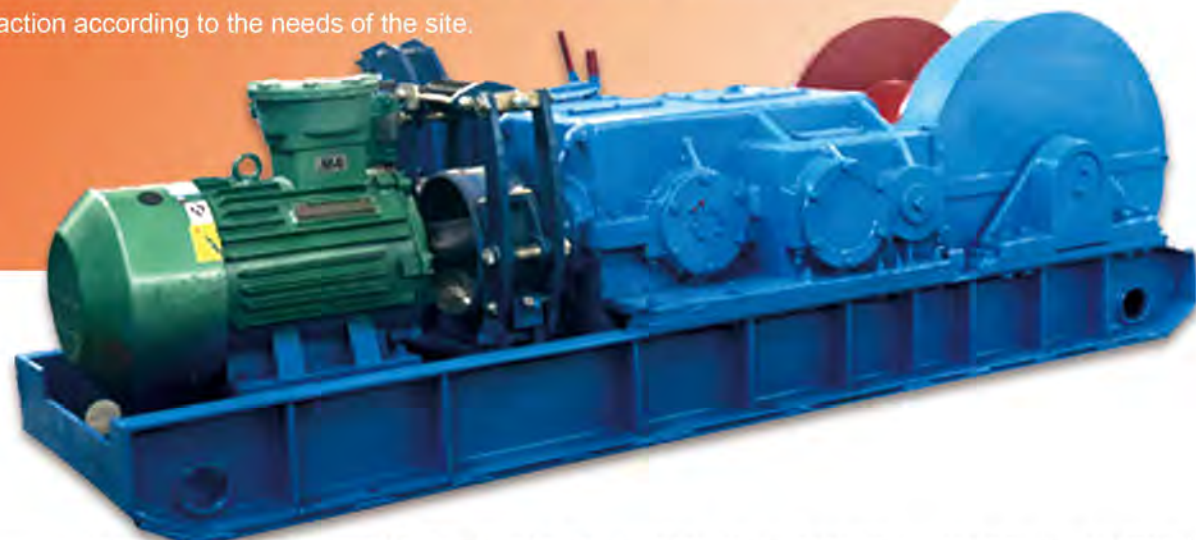

Model	JSDB-10		JSDB-12		JSDB-13		JSDB-15		JSDB-16		JSDB-19		JSDB-25		JSDB-30		
	Fast	Slow	Fast	Slow	Fast	Slow	Fast	Slow	Fast	Slow	Fast	Slow	Fast	Slow	Fast	Slow	
Wire rope static tension KN	Outer layer Max.	14.5	100	15	120	15	130	18	150	25.4	160	27.8	190	30	250	38	300
	Inner layer Max.	22.1	140	22.1	160	29.1	200	30	250	36.6	280	43.4	320	56	390	56	470
	Average	18.3	120	18.3	140	22.05	165	23	200	30.5	220	35.6	255	43	320	43	380
Wire Rope speed m/s	Max. Outer layer	1.3	0.2	1.3	0.2	1.3	0.2	1.39	0.2	1.39	0.2	1.6	0.2	1.51	0.2	1.66	0.2
	Average	1.075	0.18	1.075	0.18	1.11	0.18	1.235	0.17	1.235	0.17	1.31	0.18	4.145	0.16	1.145	0.174
Drum Size	Wire Rope Length m	120		180		180		300		300		500		500		800	
	Drum Dia.*Width	φ430x430		φ430x443		φ435x530		φ470x530		φ510x530		φ545x570		φ545x760		φ650x800	
Wire Rope size	Dia.	20		22		24		28		28		30		30		30	
	Structure	6x19															
	Nominal tensile strengthkn	1670															
Motor	Type	YBK2-200L1-6		YBK2-200L2-6		YBK2-200L2-6		YBK2-200L2-6		YBK2-250M-6		YBK2-280S-6		YBK2-280M-6		YBK3-315S-6	
	Power KW	18.5		18.5		22		22		37		45		55		75	
	Revolution rpm	970		970		970		980		980		980		980		980	
	Voltage V	660/1140		660/1140		660/1140		660/1140		660/1140		660/1140		660/1140		660/1140	
Dimension	L*W*H MM	2540x785x800		2540x785x800		3182x968x987		3260x1060x1060		3260x1060x1060		3825x1214x1470		3875x1274x1187		4750x1516x1512	
Weight (with motor) (kg)		2340		2600		3900		4400		5000		5480		7800		8200	

Lifting equipment



调度绞车
dispatch winch



回柱绞车
Prop Pulling Winch



提升绞车
Lifting winch



耙矿绞车
Scraper winch



双速绞车
Double speed winch



凿井绞车
Shaft winch



气动绞车
Pneumatic winch



无极绳绞车
Railway transport winch



运输绞车
Transport winch



风门绞车
Damper winch



卷扬机
Damper winch

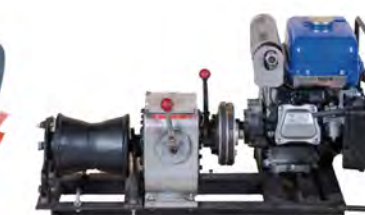

绞磨机
Cable pulling winch



绞车配件
Winch accessories



天轮
Head sheave



钢丝绳
Steel wire rope



滚轮罐耳
Roller Cage

Mining Ventilating Fan

FBD Mining fans are mainly used in coal mine underground working press-in local ventilator, suitable for local ventilation of mining face. At the same time, it is also suitable for local ventilation in other mines and various tunnel ventilation.

Model series are: K DK KCS FBD FBCD FBCDZ



KCS Mining wet dust removal fan



KCS series mining wet dust removal fan has the dual functions of ventilation and dust removal. It is mainly suitable for the in-situ purification of dusty air at the dust-producing operation point where coal dust is concentrated, and can partially eliminate the toxic and harmful components in the gas.

Ventilating Pipe

Features:

1. High tensile, shockproof, water proof, unflammable, anti-static, hot and cold resistant, acid and alkali-resistant and structure-stability.
2. temperature range : -20~+80celsius.



ZYX Series Isolated Compressed Oxygen Self-Rescuer

ZYX Series Isolated Compressed Oxygen Self-Rescuer is a reusable self-rescue escape device that uses high pressure compressed oxygen as a source of oxygen.



Model	ZYX30	ZYX45	ZYX60	ZYX120
Protect time	≥30min	≥40min	≥60min	≥120min
Capacity of oxygen bottle	0.3L	0.38L	0.4L	1.0L
Oxygen storage capacity	56L	80L	140L	240L
Quantitative supply of oxygen	1.2L/min	1.2L/min	1.2L/min	1.2L/min
Manual supply of oxygen supply	60L/min	60L/min	60L/min	60L/min
Cylinder filling pressure	20Mpa	20Mpa	20Mpa	20Mpa
weight	1.8kg	2.1kg	2.4kg	4.3kg

ZH Chemical Oxygen Self-Rescuer

ZH Chemical oxygen self-rescuer is a self-rescuer that generates oxygen through a chemical reaction. None reusable.



Item	ZH30	ZH45
Protection time (Medium labor intensity)	>30min	>45min
Temperature	≤60℃	
Dimension	140×90×175mm	100×93×133mm
Weight	1.5kg	2kg
Valid	Storage	5years
	carry	3years

Positive pressure Oxygen breathing apparatus



model	HYZ2	HYZ2C/RHZYC120	HYZ4/RHZYN240
Rated protection time (medium)	2h	2h	≥4h
Gas volume of oxygen under standard conditions	320L	320L	480L
Respiratory volume	30L/min (Severe 50L/min)	30L/min (Severe 50L/min)	30L/min (Severe 50L/min)
Quantitative oxygen supply	≥1.6L/min	≥1.4L/min	≥1.6±0.2L/min
Automatic supply of oxygen	80-100L/min	≥80L/min	≥100L/min
Dimensions mm	520×350×160	460×330×170	510×370×170
Net weight (Excluding calcium hydroxide, oxygen, blue ice)	9.5Kg	8.5Kg	9.5Kg



Positive pressure Air breathing apparatus

Model	RHZK3	RHZK6.8	RHZK9	R5100-6.8	R5300-6.8	R6100 6.8×2	
Filling gas	Air	Air	Air	Air	Air	Air	
Total weight (exclude air)	8.5Kg	9Kg	9.8Kg	9Kg	9Kg	≤15kg	
Air bottle	Inner volume	3L	6.8L	9L	6.8L	6.8L	6.8L*2 (Double air bottle)
	Cylinder weight (exclude valve)	3.5Kg	4Kg	5.3Kg	4Kg	4Kg	4Kg*2
	Material	arbon fiber composite (carbon fiber full-wound type)					

Rescue Category



氧气呼吸器校验仪
Oxygen Respirator calibrator



自动苏生器
Automatic re-suscitator



氧气填充泵
Oxygen filling pump



空气充装泵
Breathing air compressor



阻化泵
Inhibitor pump



救援三脚架
Rescue tripod



消防水炮
Fire water cannon



消防机器人
Fire Robot



液压剪扩钳
Hydraulic combi tool

RAILWAY EQUIPMENT

CHINESE STANDARD STEEL RAIL

American Standard

BS Standard

UIC860 Standard

South Africa Standard

EN Standard

Australia Standard

India Standard

DIN Standard



Railway Material



Rails



Turnout



Hydraulic Blockers



Concrete Sleeper

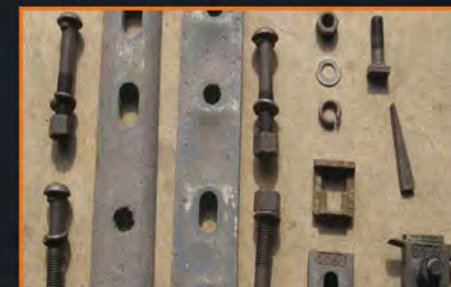

Railway Accessories



Railway Crossing Board

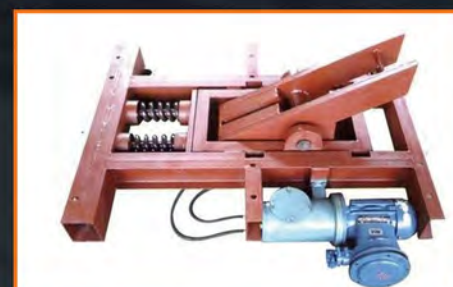

Electric Mining Car Stoper



Pneumatic Mining Car Stoper



Manual Car Stop



Mine Car Protection Device



Gasoline Rail Drilling Machine



Electric Rail Drilling Machine



Rail Cutting Machine



Electric Sawing Machine



Gasoline Tamping Machine



Hydraulic Straight Track Machine



Hydraulic Corners



Hydraulic Jack

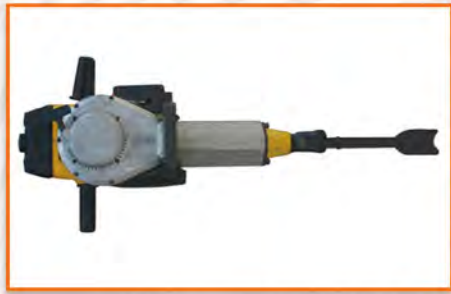

Handle Tamping Machine



Hydraulic Rail Lifting Machine



Turnout Rechanging Machine



Rail Oil Applicator



Hydraulic Rail Seam Adjuster



Rail Gauge Rod



Hydraulic Turnout Tamping Machine



Rail Grinding Machine



Profile Grinding Machine



Spikes



Rail Clip



Track Plate



Railway Bolt Wrench



Steel Track Detector

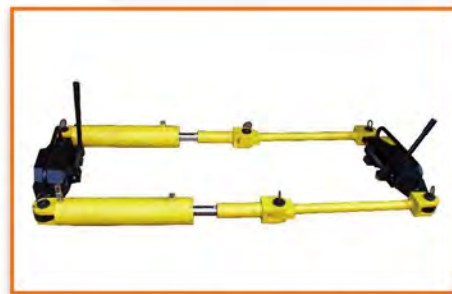

Rail Tensioning Machine



Fishtail Bolts



Plywood



Railway Accessories

EXPLOSION-PROOF ELECTRICAL

INSTRUMENTATION



Mine Lamp Cap



Mining Lamp



Miner's Lamp Charging Rack



Vacuum Feed Switch



QBZ Electromagnetic Starter

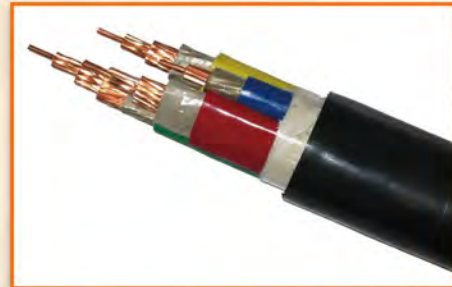

Mine Cable



Explosion-Proof Digital Camera



Explosion-Proof Camera



Sound And Light Voice Alarm



Explosion-Proof Walkie Talkie



KTH15 Explosion-Proof Telephone



Mine explosion-proof and Intrinsically safe power supply



Dust Concentration Sensor



Methane Alarm



Gas Alarm



Four In One Gas Detector



CCA1000 Direct Reading Instrument



DFA Mechanical Anemometer



Infrared Thermometer



Laser Pointing Instrument



Laser Range Finder



Methane Sensor



Temperature Sensor



Smoke Sensor

QUALIFICATION CERTIFICATE

REGISTERED TRADEMARK

